

VILLAGE of GLEN ELLYN
 Department of Planning and Development

FENCE CONSTRUCTION GUIDELINES
 for INTERIOR LOTS

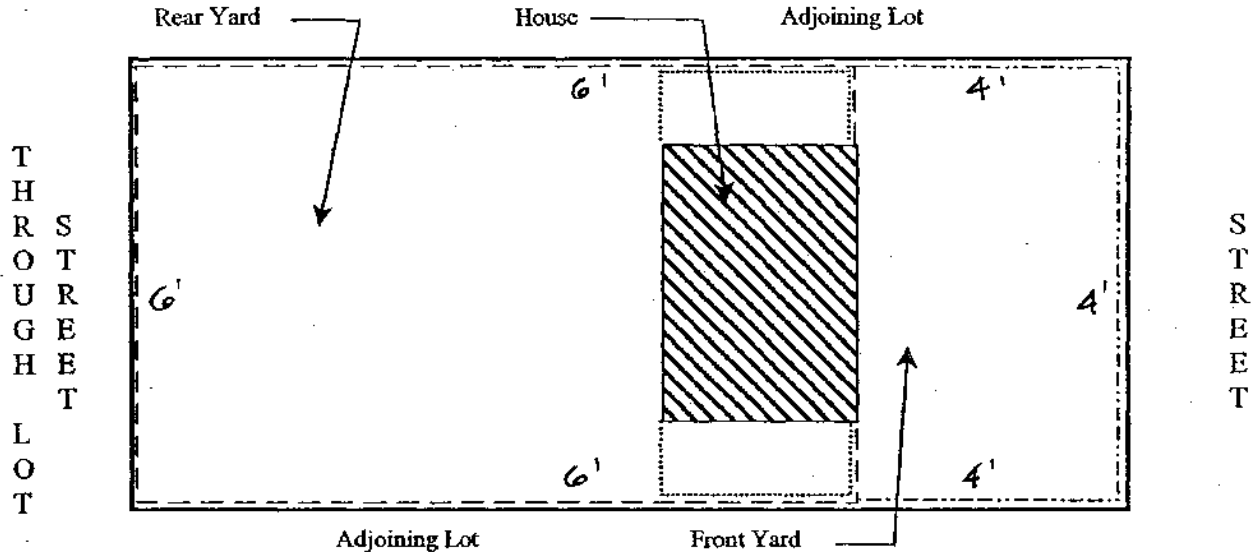

Key to Drawing:

- ✓ Property Line shown thus: _____
- ✓ Through Lot Fence shown thus: _____
 6 feet maximum height fences allowed up to the building line, but NOT BEYOND. All other fencing beyond the building line shall meet the requirements of a Front Yard Fence.
- ✓ Front Yard Fence shown thus: _____
 4 foot maximum height and a maximum of 50% solid
- ✓ Rear yard and Side Yard fences shown thus: _____
 6 feet maximum height and it can be solid

NOTES:

1. Structural elements of a fence (i.e. posts) shall face inside of property on which it is constructed.
2. Fence may be placed up to but not on property line.
3. Fence shall not be constructed in any manner which is inherently dangerous to the public (i.e. barbed wire).
4. No fence shall be erected in or over a stormwater easement.
5. It is recommended that all fences are constructed at least 3 inches from the property line.
6. A final inspection of the fence is required upon completion of the work.
7. Reminder: Call J.U.L.I.E. 48 hours before digging - 1-800-892-0123.

