

# BUILDING SUMMARY

Building Summary - Glen Elyn Hillside and Main Apex 400

Floor Areas		Net Areas							Parking Counts		Residential Counts							Apex 400
Gross	Area	Corridor	Mech	Retail	Res. Lobby, Amenities, Corridor, Leasing	Parking & Loading	Dwelling*	Public	Residential	Studio	Conv	1BR	2BR	Total	Average	EFF	Floor	
30,920	3,124	479					27,323			6	3	18	6	33	828	88%	5	
33,026	3,124	479					29,423			2	4	18	9	33	852	89%	4	
36,500	3,311	479			3,942		28,774			1	5	17	9	32	859	79%	3	
65,710	3,082	218	8,844		1,823	53,548	8,858					7	2	9	984	74%	2	
66,933	1,454	2,750	8,844		1,823	52,064		137									1	
233,103	14,098	4,405	8,844		5,765	105,613	96,478	137	139	9	12	60	28	107				
										8%	11%	56%	24%					

PARKING SUMMARY

	PROPOSED	CURRENTLY EXISTING
1ST FLOOR / PUBLIC	137 TOTAL (SEE DRAWINGS FOR SPECIFIC STALL DIMENSIONS)	122 TOTAL
2ND FLOOR / RESIDENTIAL	139 TOTAL (SEE DRAWINGS FOR SPECIFIC STALL DIMENSIONS)	0 TOTAL

COPYRIGHT: FitzGerald Associates Architects expressly reserves its copyright and other proprietary rights in these plans. These plans are not to be reproduced, changed or copied in any form or manner whatsoever, not and they to be assigned to any third party without the prior written consent of FitzGerald Associates Architects. These drawings may have been prepared for a particular project and their use for any other project is prohibited. Do not scale drawings.

2:18024 - Glen Elyn - Debb Kosich Mgmt03-Working Plan03/Supplemental Notes 18024 - Glen Elyn Apartments03.rvt  
 3/15/2019 9:26:39 AM

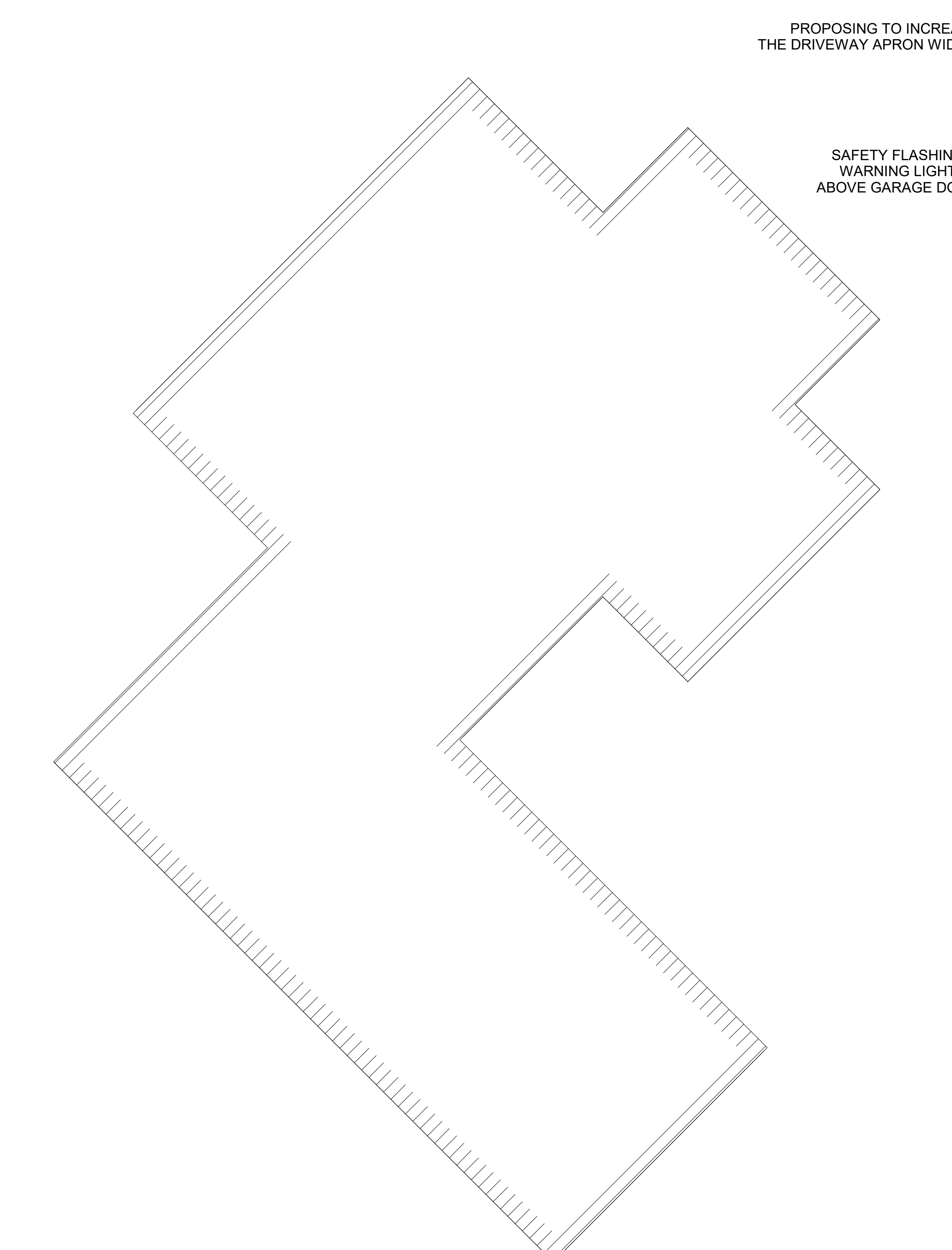

GLENWOOD AVENUE  
TWO-WAY TRAFFIC (EXCEPT SUNDAY)  
66 FT R.O.W.

STOP SIGN

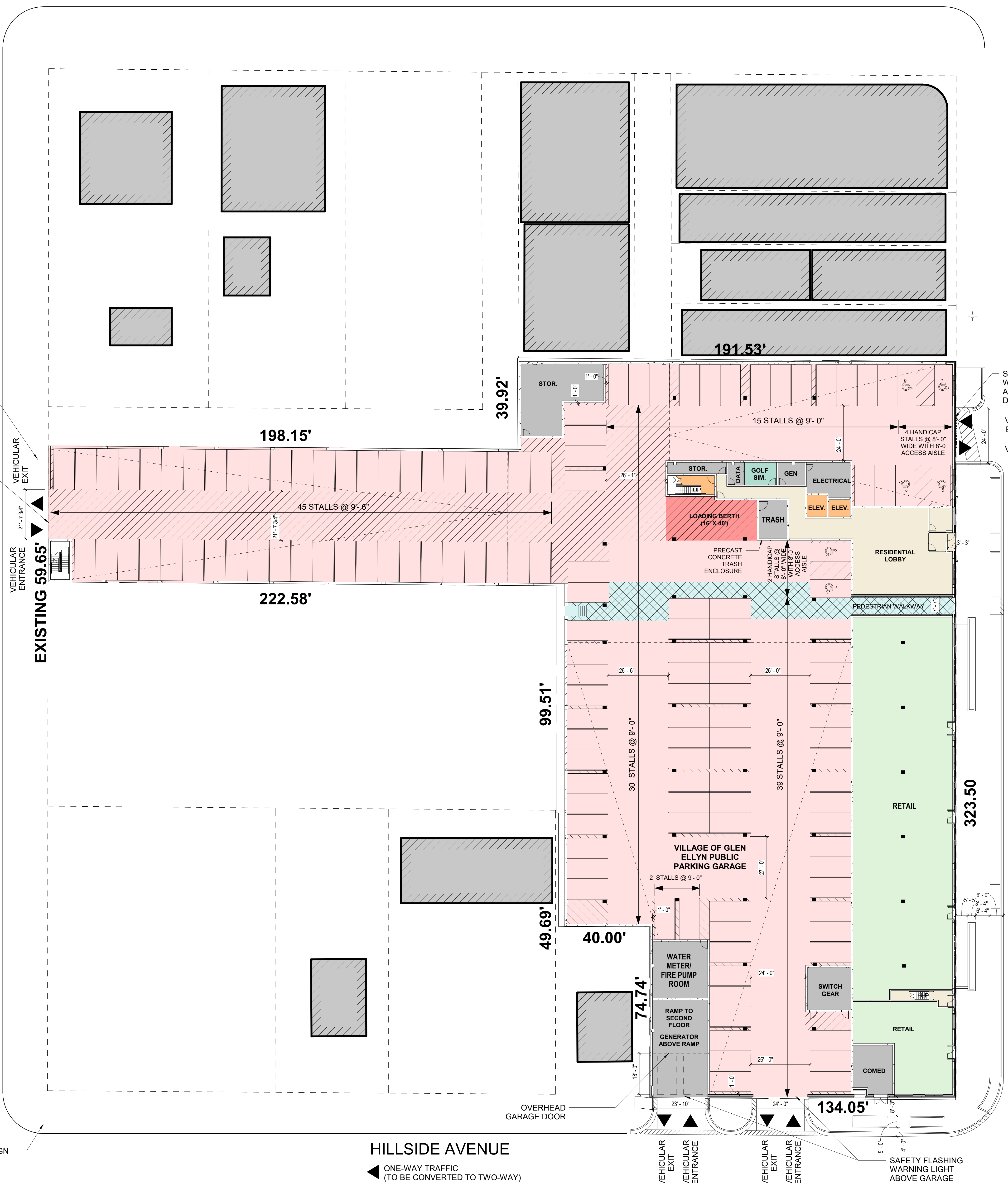

HILLSIDE AVENUE  
ONE-WAY TRAFFIC  
(TO BE CONVERTED TO TWO-WAY)  
66 FT R.O.W.

MAIN STREET  
TWO-WAY TRAFFIC  
66 FT R.O.W.

1 SITE PLAN  
1" = 20'-0"

