



Required Parking Per Code			
# of Units	Unit Type	Parking/ Unit	Req'd Parking
4	Studio	(x1)	4
47	1 Bedroom	(x1.5)	70
28	2 Bedroom	(x2)	56
7	2 BR + Den	(x2)	14
86	TOTAL UNITS		144
			TOTAL REQ'D

1 space for each 250 square feet of gross floor area:
 $1203/250 = 4.8$ spaces

	149	TOTAL CODE REQ'D PARKING
--	-----	--------------------------

Proposed Apartment Parking		
Number of Spaces	Location	Type
54	Lower Level	Conditioned
50	Main Level	Conditioned
0	Main Level	Outdoor
104	TOTAL SPACES	

104 Resident Spaces

$104 / 86$ Units = 1.2 Spaces / Unit

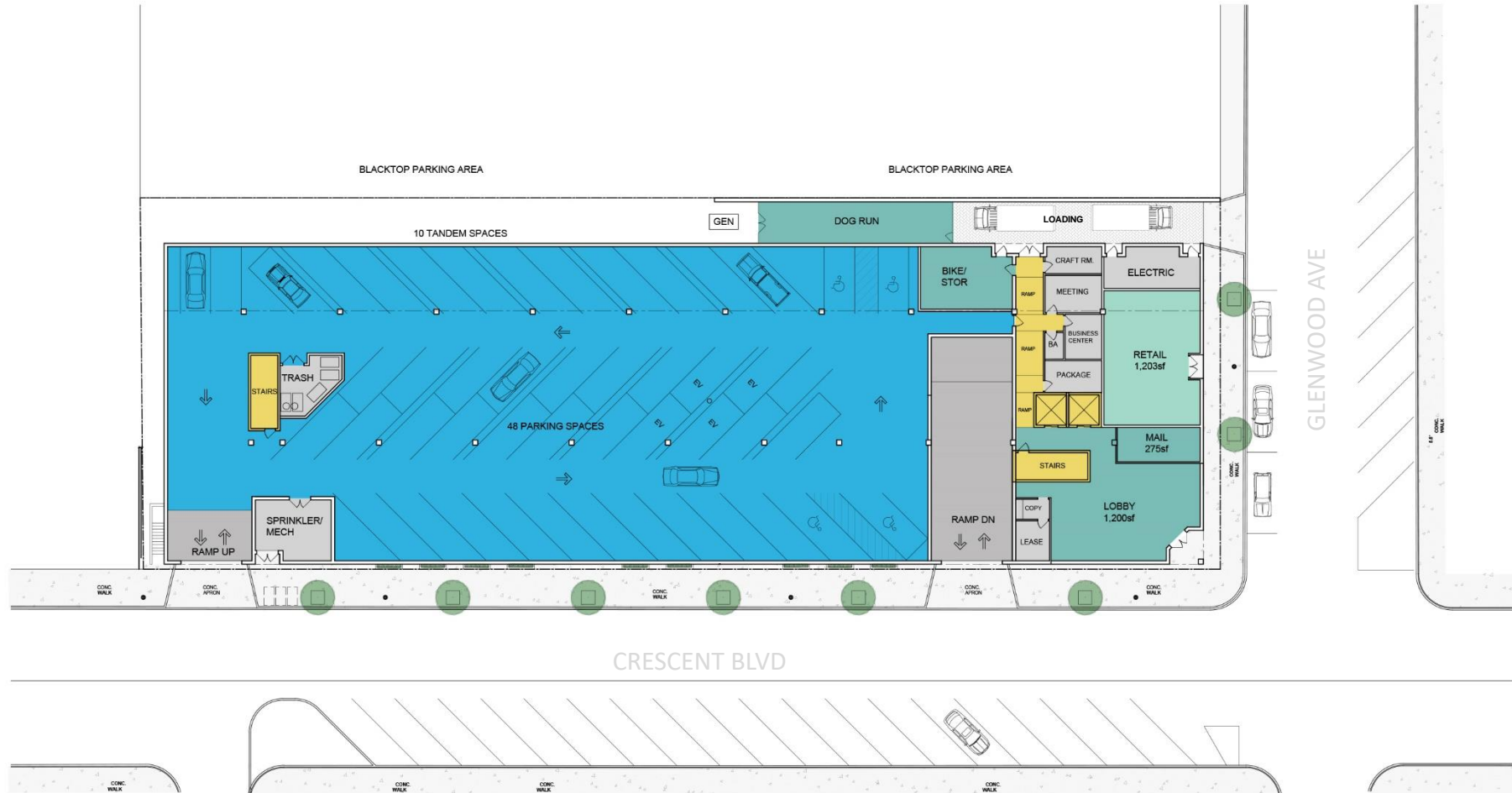

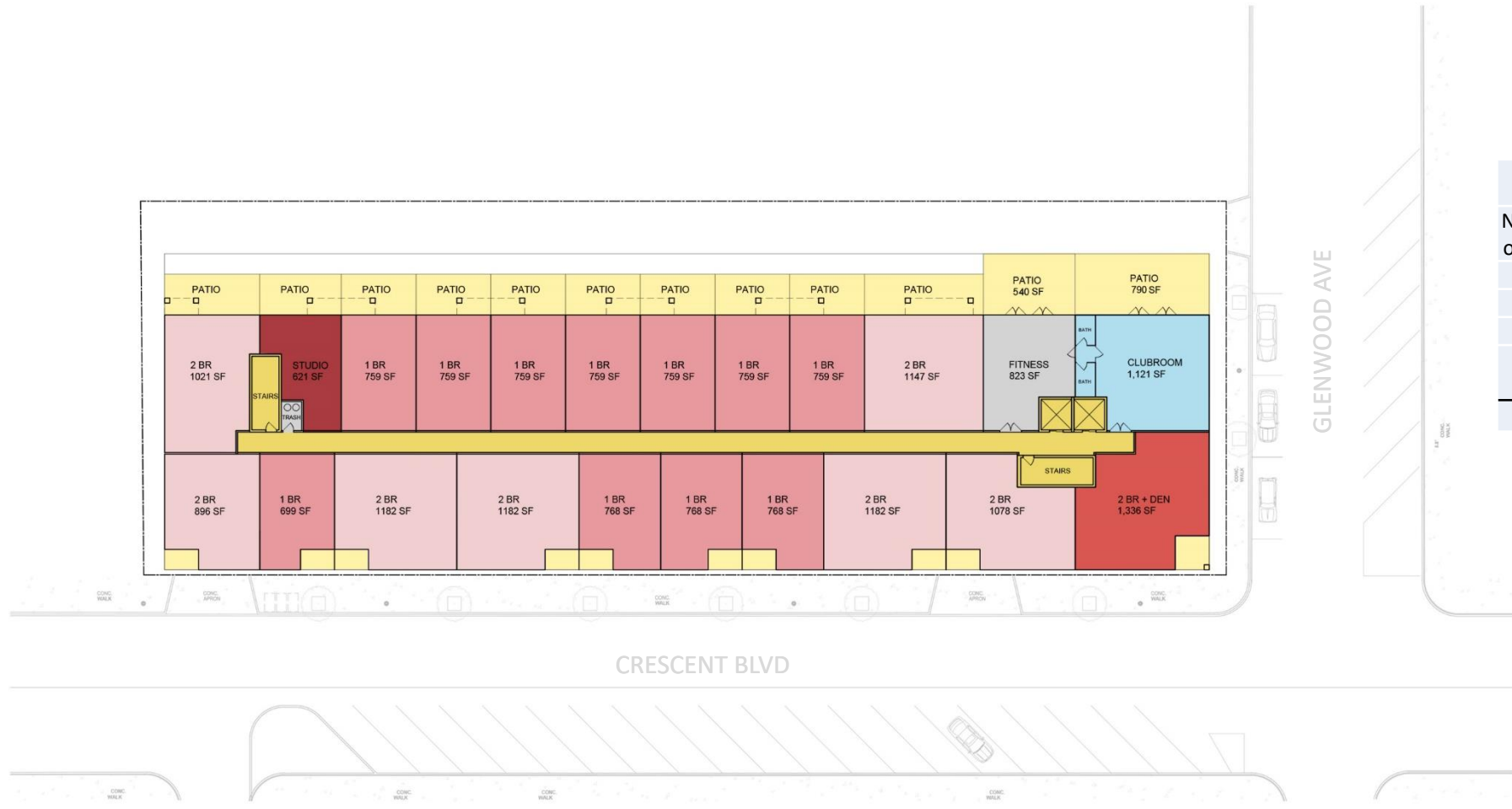

Apartment Data			
Number of Units	Unit Type	Unit Square Footage	Mix %
4	Studio	621	4.6%
47	1 Bedroom	699 - 768	54.6%
28	2 Bedroom	896 - 1,182	32.5%
7	2 Bedroom + Den	1,166 - 1,336	8.1%
86	TOTAL UNITS		

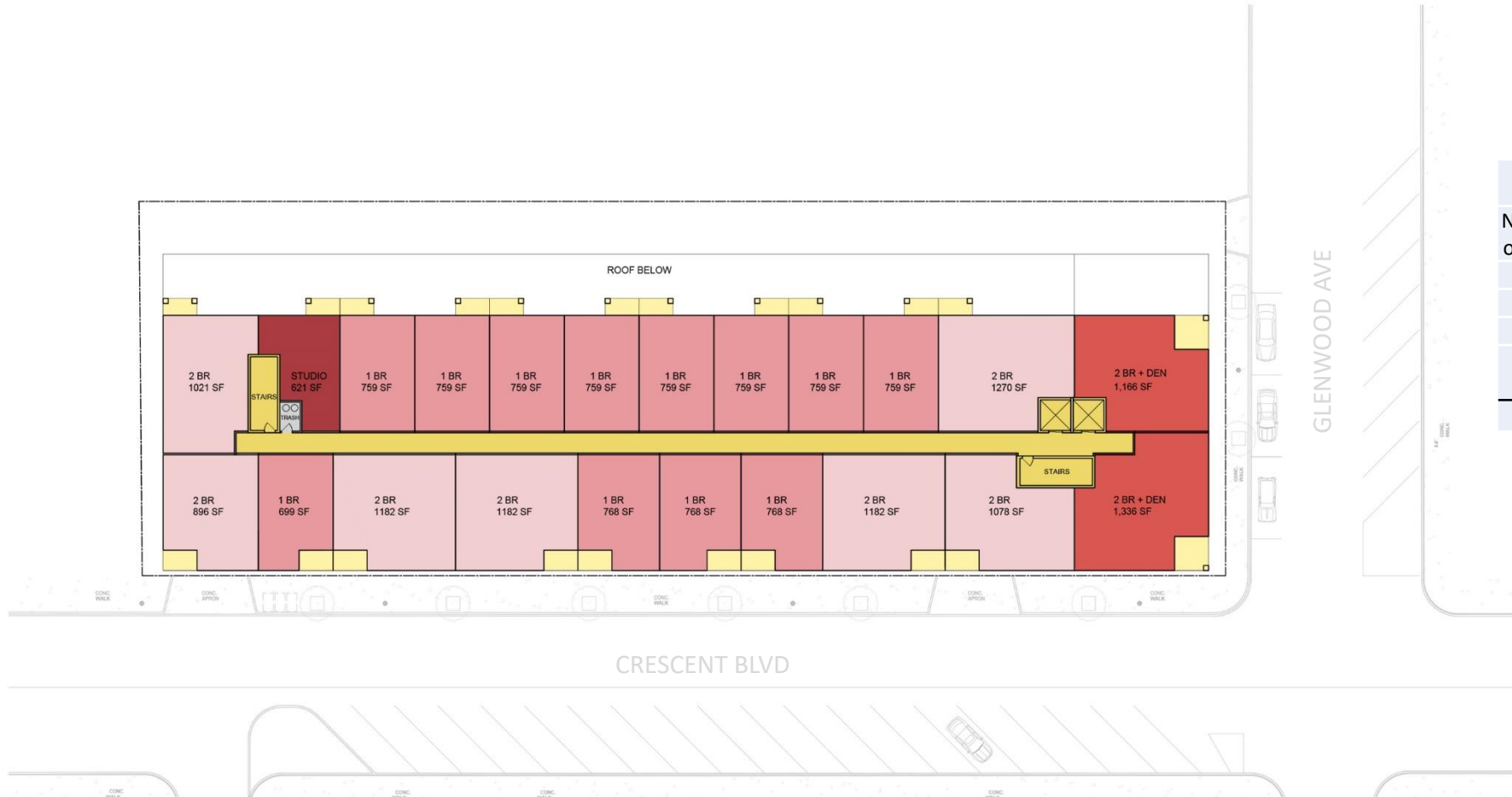

Apartment Data			
Number of Units	Unit Type	Unit Square Footage	Mix %
4	Studio	621	4.6%
47	1 Bedroom	699 - 768	54.6%
28	2 Bedroom	896 - 1,182	32.5%
7	2 Bedroom + Den	1,166 - 1,336	8.1%
86	TOTAL UNITS		